

***D-7***

***Electric Corner Rounding Machine***



**OPERATION MANUAL**

## Labeled Drawing

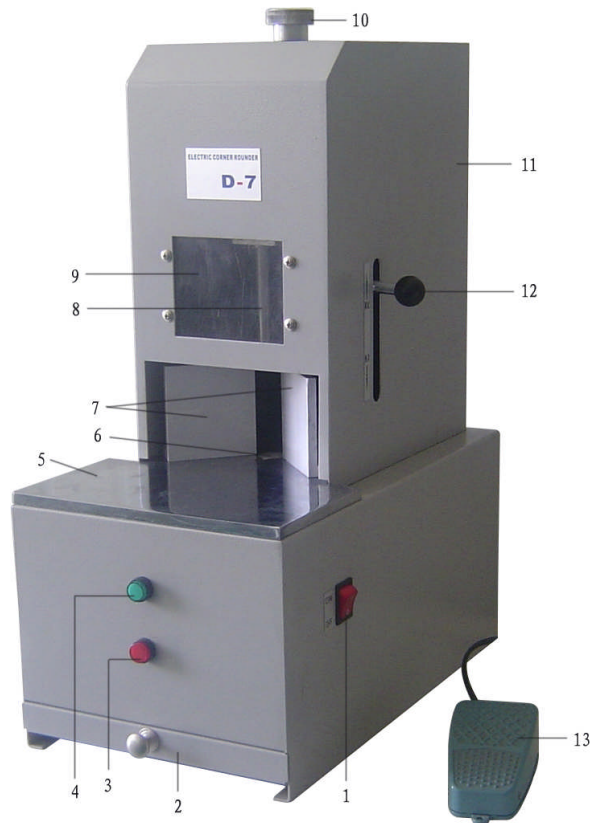

- |                              |                                 |
|------------------------------|---------------------------------|
| 1. Main switch               | 2. Wastepaper collecting drawer |
| 3. Power indicator light     | 4. Cutter changing knob         |
| 5. Operating table           | 6. Protect cushion              |
| 7. Orient guard              | 8. Cutter plate                 |
| 9. Transparent viewing panel | 10. Cutter adjustment knob      |
| 11. Bonnet                   | 12. Press handle                |
| 13. Pedal switch             |                                 |

## Operation Description

1. Put the machine on the steady platform, and install the pedal switch.
2. Open the switch, adjust the required rounding angle (press the handle on the right side, and turn the cutter changing knob, then rotate cutter plate, make sure of the required angle value fitting the cutting edge).
3. Put all the materials on the machine and tighten the orient guard.  
※ Place both hands on the outside of machine.
4. Step on the pedal switch to finish the cutting rounding operation.

## Cutter changing steps

1. Adjust the cutter to the required position.



2. Press cutter changing knob.



3. Close the switch when the cutter is located at the lowest level, open the bonnet according to the following step.

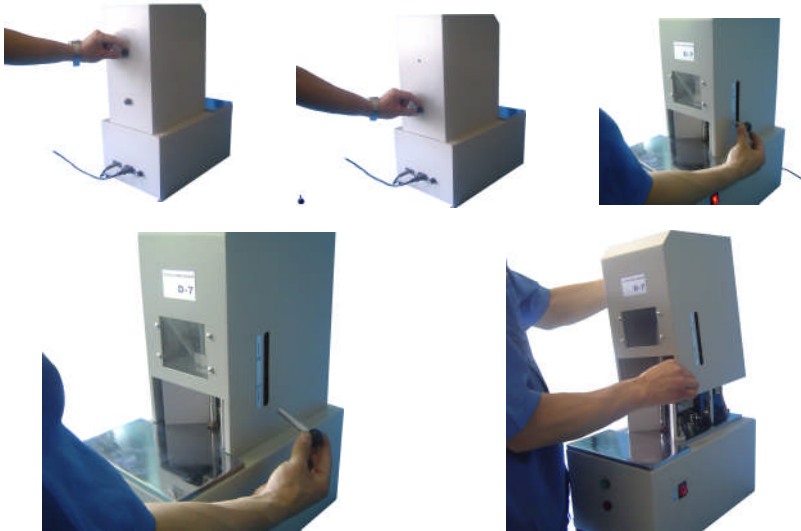

4. Put the template into cutter trough which is the same value with the angle of changing, and tighten it.

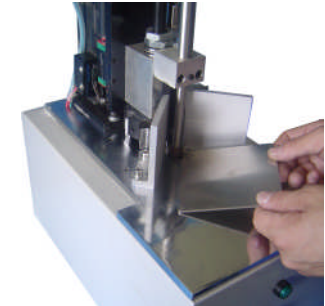

※ Normal equipped with the template for adjustment of angle.

5. Unscrew the fixed screws of both sides of guards, adjust two guards to stay close to both sides of the template, and meet at an angle of 90 degrees.

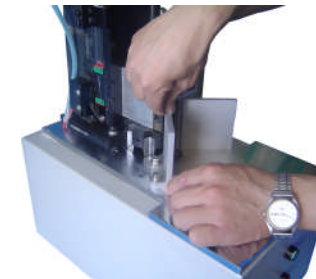
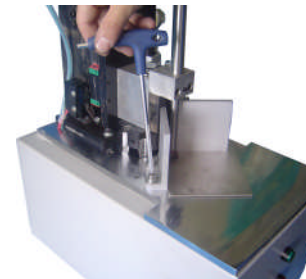

6. After finishing adjusting, tighten the fixed screws of both sides of guards to complete the adjustment of angle.

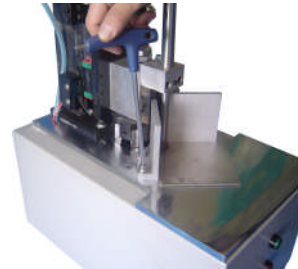

7. Check to see if the cutter is stay close to the protect cushion. Loosen the fixed nuts first if there is interval, rotate spiral shell pole with spanner to adjust upper or lower position of cutter, then unloosen the nuts.

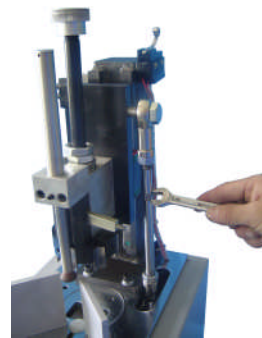
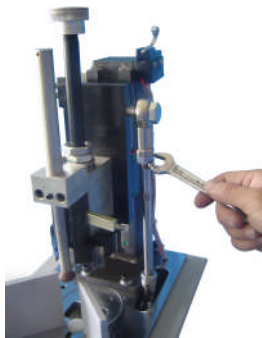

8. Reinstall the machine according to the order of the disassembling finally, and open cutter adjustment knob, the whole work is complete.